

# 樹木園境

Tree & Landscape Map



屯門區  
Tuen Mun District

新界系列(二)

New Territories Series  
No. 2



發展局 綠化、園境及樹木管理組

Greening, Landscape and Tree Management Section Development Bureau

# 引言 Foreword

## 人樹共融 綠滿家園

發展局 綠化、園境及樹木管理組編寫的樹木園境地圖，重點介紹香港各區的綠化園境資產，讓市民認識、欣賞及享受綠化空間與樹木帶來的樂趣。

## People, Trees, Harmony

This Tree & Landscape Map prepared by the Greening, Landscape and Tree Management Section, Development Bureau, aims to highlight the greening and landscape assets in different parts of Hong Kong, so as to promote the understanding, appreciation and enjoyment of open spaces and trees.

## 封面照片

上：蝴蝶灣公園  
中：屯門公園  
下：屯門海濱花園

## Cover Photos

Top: Butterfly Beach Park  
Middle: Tuen Mun Park  
Bottom: Tuen Mun Promenade



屯門  
Tuen Mun



# 新界 New Territories Tuen Mun

## 屯門

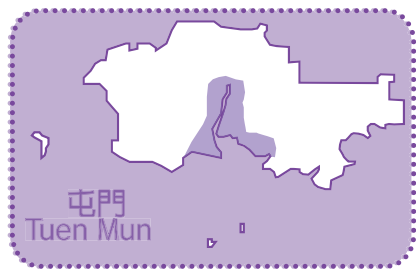

古樹名木  
Old and Valuable Tree (OVT)

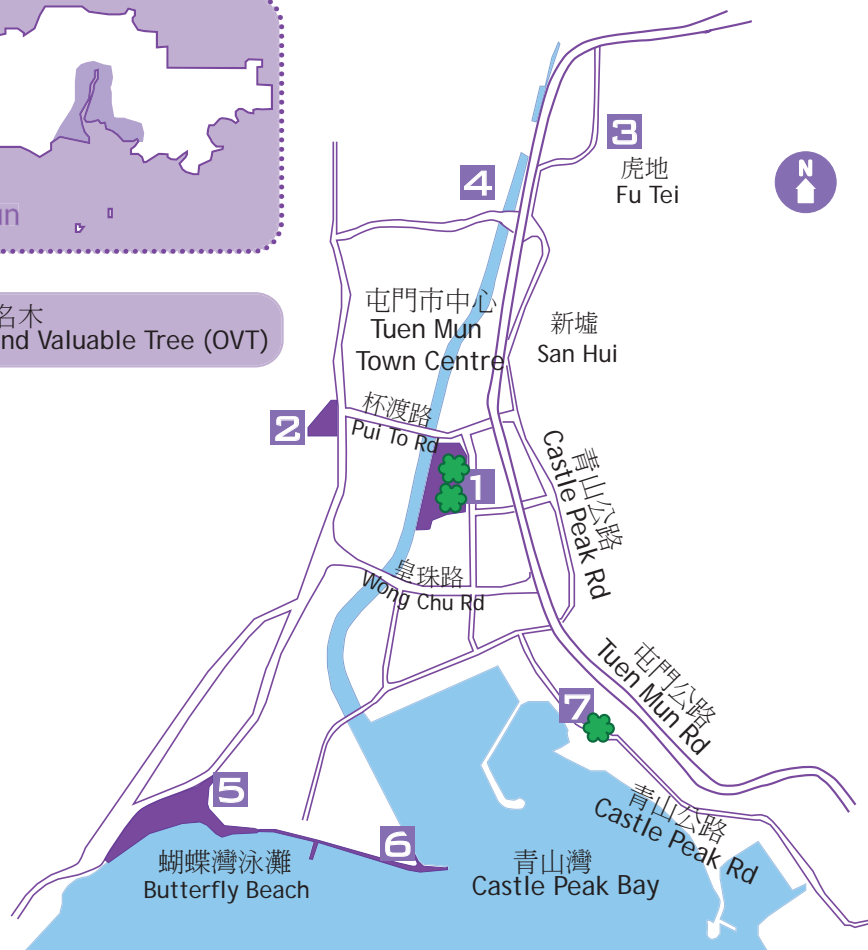

屯門位處於新界西面的青山山麓。由於位處海岸地帶，早於唐代時期已是海防重鎮。屯門區在80年代初發展成為本港第一代新市鎮之一，是新界其中一個最大的住宅區。在綜合的城市規劃下，區內的休憩空間規劃完善，設計得宜，既能配合市中心眾多居民的需要，又可將沿岸的康樂設施連接起來。



1 屯門公園  
Tuen Mun Park



2 楊小坑錦簇花園  
Yeung Siu Hang Garden



3 嶺南大學  
Lingnan University



4 青松觀  
Ching Chung Koon



5 蝴蝶灣公園  
Butterfly Beach Park



6 屯門海濱花園  
Tuen Mun Promenade



7 青山灣泳灘古樹名木  
Old and Valuable Tree at  
Castle Peak Beach

Tuen Mun is located at the foot of Castle Peak in the west of the New Territories. As early as the Tang Dynasty, it was already an important naval town due to its coastal location. In the early 1980s, Tuen Mun was developed into one of the first generation new towns and is now one of the largest residential areas in the New Territories. With comprehensive town planning, the open spaces in Tuen Mun are well planned and designed, catering for the needs of the densely populated town centre on the one hand, and linking up the coastal recreational facilities on the other.



# 屯門公園

## Tuen Mun Park

1

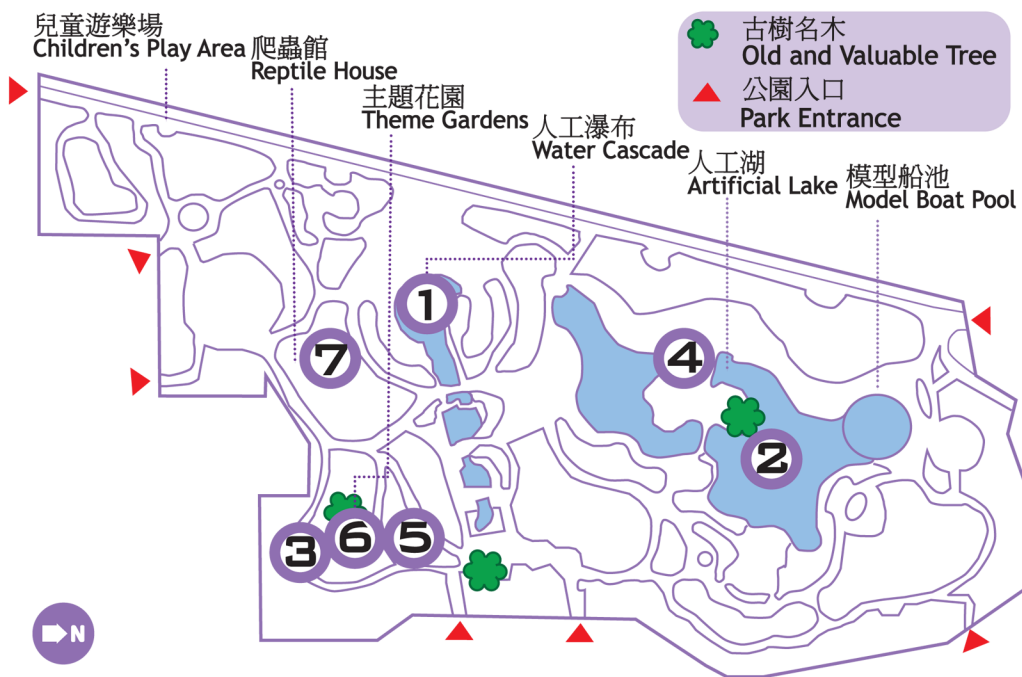

屯門公園位於屯門市中心，毗鄰屯門大會堂、屯門中央圖書館及港鐵西鐵線屯門站，為新界首個提供多種康樂設施的大型公園，於1985年至1991年分階段啟用。公園的總面積為12.5公頃，園中央設有一個面積約1公頃的人工湖與小瀑布。公園東南方則建有多個主題各異的小園區，是遊人拾趣的好去處。

Opened in phases between 1985 and 1991, and located at the Tuen Mun town centre near the town hall, public library and MTR West Rail Line Tuen Mun Station, Tuen Mun Park is the first major park in the New Territories provided with a wide range of recreational facilities. The park has a total area of 12.5 hectares, with a 1-hectare artificial lake and a water cascade at the centre. Various theme gardens at the southeastern part of the park are points of interest for visitors.





4

湖面的倒影令公園更添魅力  
The lake's reflection adds charm to the park

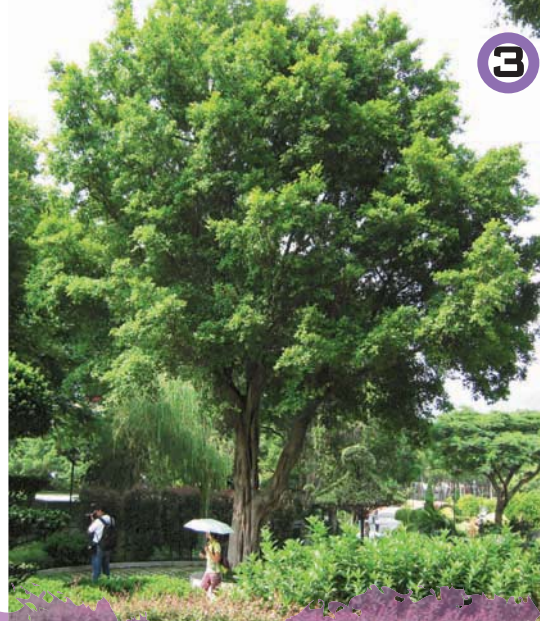

3



2

波平如鏡的湖面營造出  
寧靜平和的氣氛  
The calm surface of the  
lake creates an  
atmosphere of peace  
and serenity.



5

綠樹成蔭的草坪  
A lawn surrounded by tall green trees



\* 土生植物  
Native Species

細葉榕  
Chinese Banyan \*  
(*Ficus microcarpa*)



洋金鳳奪目綻放  
An eye-catching Dwarf Poinciana  
(*Caesalpinia pulcherrima*) in bloom



經過剪型的垂葉榕間距整齊，形成一種節奏  
Clipped Weeping Figs (*Ficus benjamina*) planted at  
identical intervals creating  
a rhythm



6



由一排剪形龍柏構成的矮綠籬  
A row of clipped Dragon Junipers (*Juniperus*  
*chinensis* cv. *Kaizuca*) forming a low green fence



路旁的澤米蘇鐵(牙米加蘇鐵)為遊人引路  
Jamaica Sagotrees (*Zamia furfuracea*) planted on both sides of the paths

7





## Yeung Siu Hang Garden

Situated at the end of Yeung Tsing Road, the 3-hectare Yeung Siu Hang Garden was opened in 1990. The garden was designed against a skyline background, with Castle Peak in the distance and complemented by water feature, terraced garden and some pocket spaces with different themes. Blessed with greenery and trees, the garden is a popular open space for the locals.

## 楊小坑錦簇花園

楊小坑錦簇花園位於楊青路盡頭，佔地3公頃，於1990年啟用。花園遠眺青山，其設計以藍天下的山脊為背景，配以特色水池、梯臺花園及主題各異的小型休憩空間。花園綠蔭處處，成為廣受大眾歡迎的休憩空間。

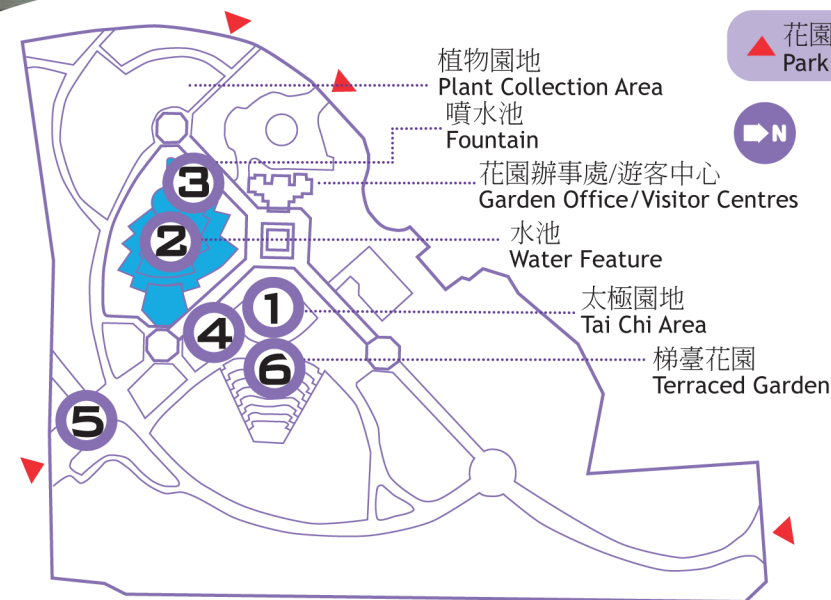





1 水池  
Water feature



2 噴水池  
Fountain



4 沿路種滿植物，一片青翠碧綠  
Plants in different tones of green along the path



5 東南面入口的林蔭大道  
Tree avenue at the southeast entrance



3 牛型雕塑靜卧一角  
An ox sculpture sitting quietly in a corner



水池旁的美人樹長滿悅目的粉紅色花朵  
The Silk Floss Tree (*Ceiba speciosa*) with showy pink flowers by the pool



6 梯臺花園  
Terraced garden







## 嶺南大學

嶺南大學於1995年遷往現時位於屯門的校址，其整體建築風格與廣州的嶺南大學一脈相承。另外，校園中央部分有三組風格各異的園景設計，分別是余近卿紀念園的水元素、現代花園的梯臺和永安廣場的露天廣場。

## Lingnan University

Lingnan University moved to the current Tuen Mun campus in 1995 and its overall architectural style was inspired by the Lingnan University in Guangzhou. Located at the heart of the campus are three landscape features of different styles, namely, the water elements in Yu Kan Hing Memorial Garden, the terraces in Contemporary Garden, and the open piazza in Wing On Plaza.

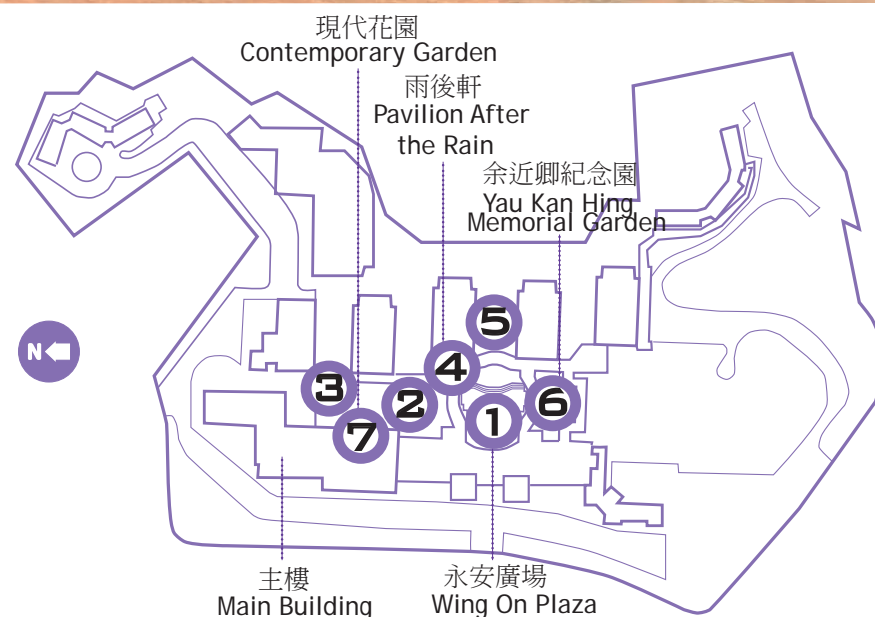
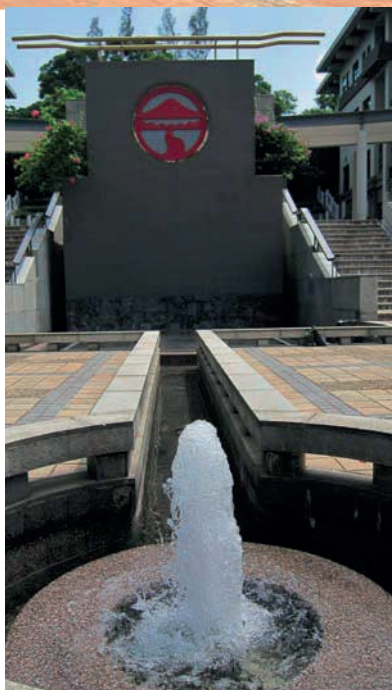





2 孫中山先生像  
Dr. Sun Yat-sen Statue



休憩處  
Sitting-out area



現代花園內的梯臺花壇  
Terraced planter in  
Contemporary Garden

3



6 余近卿紀念亭  
Yau Kan Hing Memorial Pavilion



4 雨後軒  
"Pavilion After the Rain"



7 現代花園  
Contemporary Garden

3



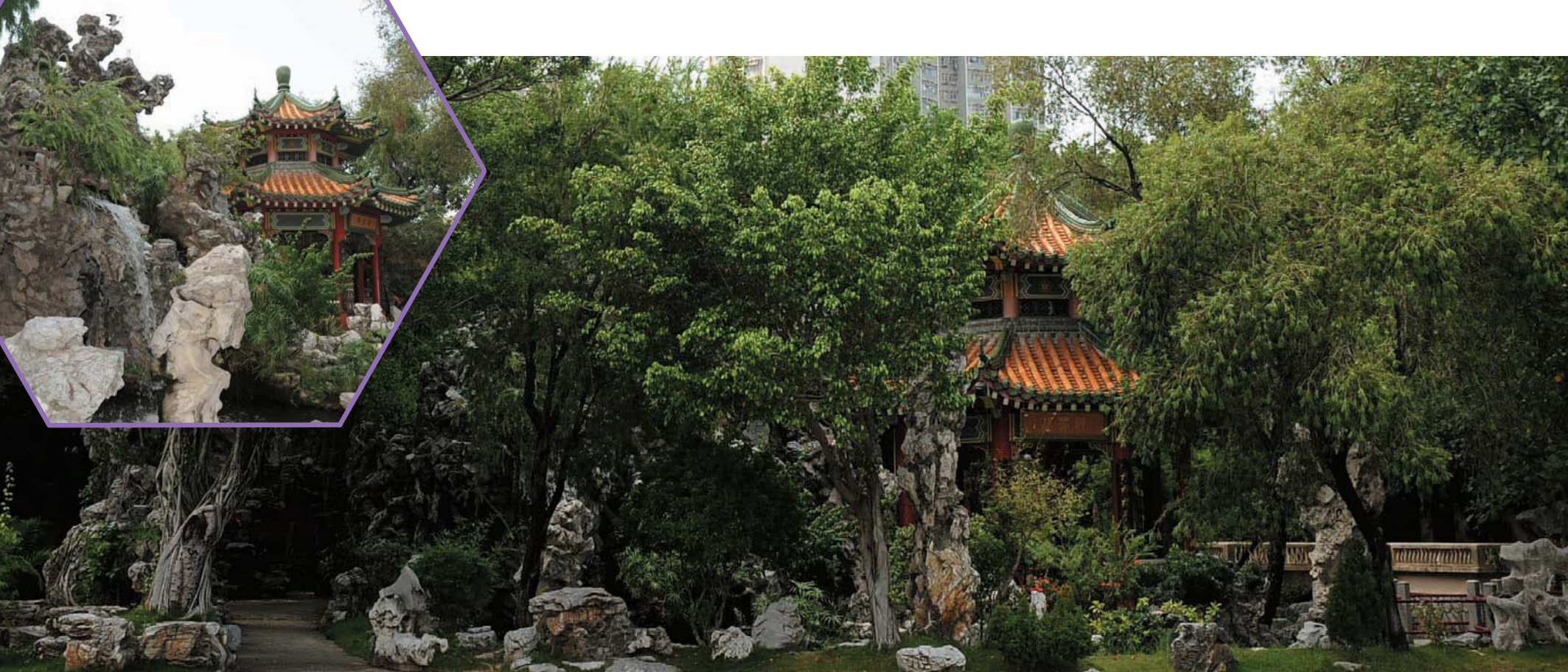

**青松觀** 是一所道觀，創建於1949年。青松顧名思義是指常綠的松樹。種植於道觀的松樹數目不多，卻大都樹型優美，並能融入中式傳統建築風格中。道觀範圍南端設有一個小型中式花園，綠樹成蔭，湖與亭之間奇石錯落，氣氛安祥寧靜。

**Ching Chung Koon** is a Taoist temple opened in 1949. "Ching Chung" as its Chinese name suggests is "evergreen pine trees". Though there are not many pine trees in the temple, many of them are mature trees in good form which blend with the traditional Chinese architectural style of the temple. The spreading and shady trees and unique rocks of different shapes and forms scattered between the lake and pavilion have created a tranquil atmosphere for the small Chinese garden at the south end of the temple.



a 雞蛋花  
Frangipani  
(*Plumeria acutifolia*)



b 白蘭  
White Jade Orchid Tree  
(*Michelia × alba*)



c 龍眼  
Longan  
(*Dimocarpus longan*)



d 細葉榕  
Chinese Banyan  
(*Ficus microcarpa*)



盛開的松葉牡丹  
Blooming Rose-moss (*Portulaca grandiflora*)





# 蝴蝶灣公園

## Butterfly Beach Park

蝴蝶灣公園毗鄰蝴蝶灣泳灘，佔地共6.63公頃，於90年代初啟用。公園除了提供露營營地和燒烤區等動態休憩設施外，亦有配合海濱環境的靜態園境空間，更設有特色瞭望亭讓遊人飽覽海濱全貌。





2

燒烤區附近的中式花園  
A Chinese Theme Garden near the barbecue area



快餐亭旁的花園  
A garden by the kiosk

3



人工湖  
Lagoon

4

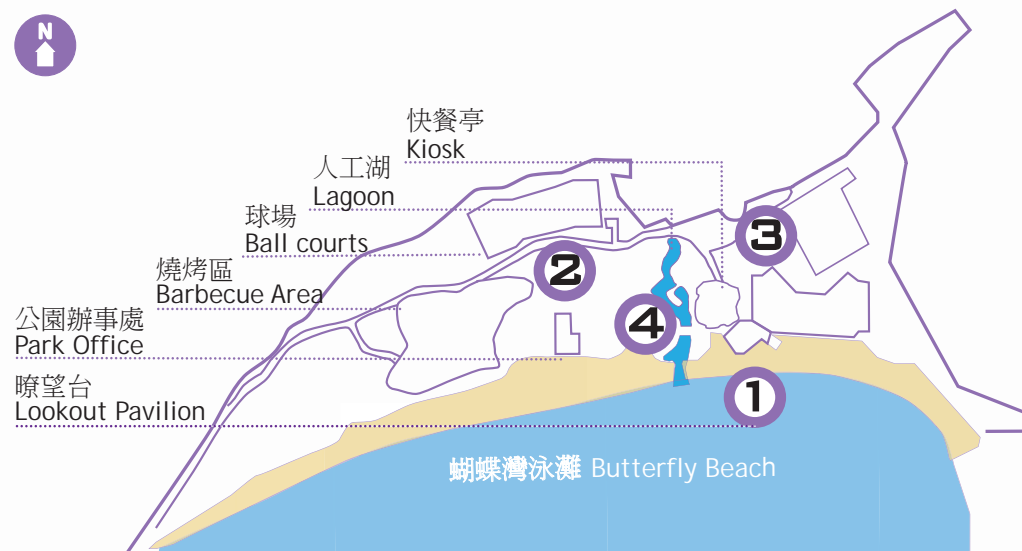

The 6.63-hectare Butterfly Beach Park near the Butterfly Beach was opened in the early 1990s. Apart from active recreational facilities such as camping sites and barbecue areas, the park also features a quiet landscaped area with a harbour-front location, as well as a lookout pavilion for visitors to enjoy the full view of the harbour.

5

蝴蝶灣公園

BUTTERFLY BEACH PARK



## 屯門 海濱花園

位於屯門臨海住宅區旁邊，於90年代初啟用，其後於2010年起分階段進行改善工程。花園內樹木濃蔭茂密，不單成為高樓大廈與海濱長廊之間的緩衝，更巧妙地把陸地和大海連接起來。

## Tuen Mun Promenade

was opened in the early 1990s and has been under improvement works in phases since 2010. Situated along the sea front close to the residential area, the promenade with lush green trees not only forms a buffer between the high rise buildings and the promenade, but also creates a smooth transition from the land to the sea.





細葉榕的氣根多得驚人!其實這些氣根不單可以收集養份,當它們生長至地面時更有助支撐大樹。

You will be amazed by the number of aerial roots in a Chinese Banyan Tree (*Ficus microcarpa*)! The aerial roots are not only for collecting nutrients, but also can help support the tree when they reach the ground.



細葉榕

Chinese Banyan \*  
(*Ficus microcarpa*)

\* 土生植物  
Native Species

圖中所見的細葉榕身高28米,樹幹直徑為1.3米,屹立於青山灣旁的停車場,其樹冠枝葉茂盛,形態舒展,引人注目,是泳灘最佳的迎賓標記。

This Chinese Banyan (*Ficus microcarpa*), with a height of 28m and a trunk diameter of 1.3m, stands proud and tall at the car park next to the Castle Peak Beach. Its dense and spreading tree crown not only captures visitors' attention, but also serves as a landmark for beachgoers.



版權 © 2015年 樹木園境地圖

版權所有 未經許可 不得複製

編著 : 綠化,園境及樹木管理組

出版 : 香港特別行政區政府 發展局

承印 : 政府物流服務署

(使用環保油墨和紙張印製)

版次 : 2012年10月第一版

2015年1月第二版

國際書號 : 978-988-16821-1-6

© 2015 Tree and Landscape Map

All Right Reserved, Unauthorized reproduction prohibited

Compiled by : Greening Landscape & Tree Management Section

Published by : Development Bureau

The Government of the Hong Kong Special Administrative Region

Printed by : Government Logistics Department

(Printed with environmentally friendly ink and paper)

Edition : First Edition, October 2012

Second Edition, January 2015

ISBN : 978-988-16821-1-6