

樹木園境 Tree & Landscape Map 地圖

增訂版
Augmented Edition



發展局 綠化、園境及樹木管理組
Greening, Landscape and Tree Management Section, Development Bureau



可掃描二維碼瀏覽網頁
Scan QR code to browse the website

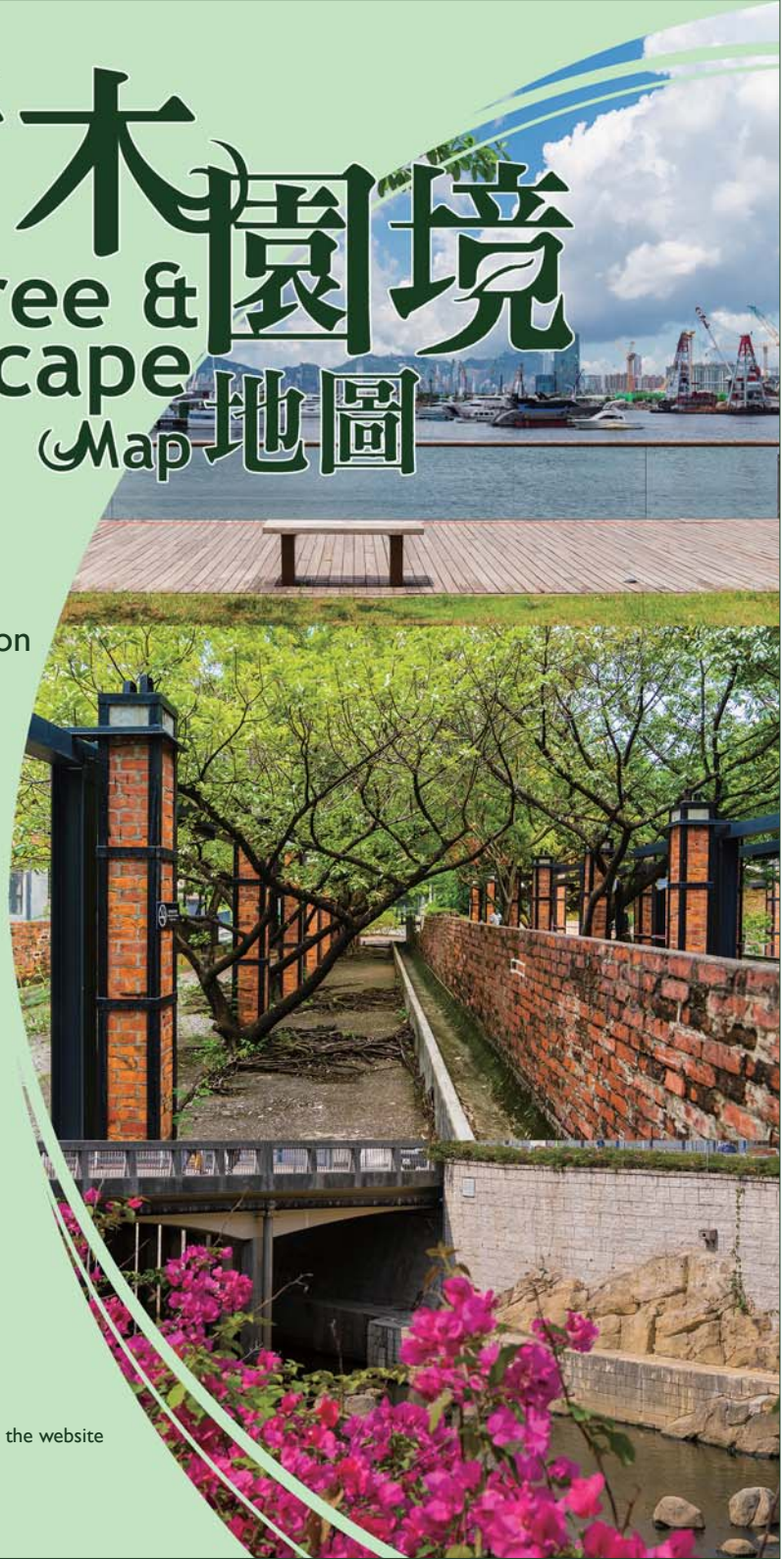

引言

“發展局綠化、園境及樹木管理組於 2012 年首次出版《樹木園境地圖》系列，向市民介紹香港各區的綠化園境資產。

2025 年增訂版的《樹木園境地圖》旨在讓市民認識綠化園境的新資源，並欣賞及享受綠化空間與樹木帶來的樂趣。

隨著近年的城市發展及舊區活化，各區都增添和更新了不少綠化空間。近期落成的綠化空間在功能、景觀、生態等方面持續優化，並融入藍綠基建元素，以加強面對氣候變化的抗禦性，提升城市的宜居度和可持續發展，並以前瞻性的規劃及設計配合市民身心健康需要。

FOREWORD

The Greening, Landscape and Tree Management Section of the Development Bureau first published the "Tree and Landscape Map" in 2012, with the aim to promote the greening and landscape assets in different parts of Hong Kong to the general public.

The 2025 augmented edition to the "Tree and Landscape Map" aims to foster the understanding on these new green assets, as well as the appreciation and enjoyment by the general public brought by green spaces and trees.

Many green spaces have been formed or refurbished in various districts under recent urban development and renewal. These recently completed green spaces have been further optimised in terms of functionality, landscape quality and ecological consideration by integrating blue green infrastructure elements. The resilience against climate change and the livability and sustainability of the city as a whole has been enhanced. They are planned and designed with visions to address physical and mental health needs of the public.”

目錄 CONTENT

觀塘區 Kwun Tong District



觀塘海濱花園
Kwun Tong Promenade



駿業街遊樂場
InPark



海濱道公園
Hoi Bun Road Park



茶果嶺海濱公園
Cha Kwo Ling Promenade



翠屏河畔長廊
Tsui Ping Riverside Promenade

黃大仙區 Wong Tai Sin District



啟德河
Kai Tak River

九龍城區 Kowloon City District



啟德郵輪碼頭公園
Kai Tak Cruise Terminal Park



牛棚藝術公園
Cattle Depot Art Park

觀塘區

Kwun Tong District

九龍東正積極轉型為本港第二個「核心商業區」(CBD2)，其中觀塘區的發展引人注目。這裡不僅有優質商貿進駐，亦同時引入藝術、文化和創意等行業，增添了區域的活力。透過採用富地方色彩的城市設計，以連繫、創新和低碳的設計概念，推動區內主要街道、海濱和其他公眾休憩用地逐步優化，令觀塘區更具吸引力。

Kowloon East is actively transforming into Hong Kong's second Core Business District (CBD2), with notable advancement in the Kwun Tong district. This area has not only settled with premier businesses, but also attracted arts, culture and creativity industries, which in turn enhances the vibrancy of the district. Through strategic urban design that coheres with the local history of Kwun Tong, along with concepts of connectivity, innovation and low carbon, many key streets, waterfront and other public recreational spaces within the district have gradually been revitalised, making the Kwun Tong district more appealing.

2012 年版內容
Content of 2012 Edition

2025 年增訂版內容
Content of 2025 Augmented Edition



觀塘海濱花園
Kwun Tong Promenade



海濱道公園
Hoi Bun Road Park



翠屏河畔長廊
Tsui Ping Riverside Promenade



駿業街遊樂場
InPark



茶果嶺海濱公園
Cha Kwo Ling Promenade



KT
01

觀塘海濱花園 *Kwun Tong Promenade*

佔地超過 4 公頃的觀塘海濱花園提供約 1 公里長的海濱步道、特色塔樓地標、音樂噴泉以及各種設施。另外，為了將自然帶入城市，長廊上種了充滿特色的植物和廣闊的草地。玻璃欄杆無阻市民與大海的距離，我們可飽覽維多利亞港的全景。紙張裝卸是觀塘公共貨物起卸區昔日的日常情景。將廢紙回收再造業的特色融入於建築物當中，令公園設計更別具一格。

Occupying an area of over 4 hectares, Kwun Tong Promenade provides a 1 km long seaside boardwalk, a landmark tower, musical fountains and a variety of other facilities. Designed to bring nature into the city, abundant amount of plants and lawns are provided. Glass balustrades improve visual access to the sea and provide an unobstructed panorama of the Victoria Harbour. Loading and unloading of paper was a daily scene of the former Kwun Tong Public Cargo Working Area. Features representing the paper recycling industry have been blended into the design of facilities which signified the special character of the promenade.

KT
01

觀塘海濱花園

Kwun Tong Promenade



園境的建築物反映了海濱花園前身為公眾貨物裝卸區的特色，貫徹樸素、工業風的風格。左圖的棚架外形設計的靈感來自碼頭舊船裝卸廢紙的起重架，反映觀塘公眾貨物裝卸區的歷史及當時碼頭的用途。

The structures in the landscape reflect the character of the former industrial use of the area. The shapes of the trellis on the left was inspired by cargo container cranes for loading and unloading waste paper, reflecting the history of the former Kwun Tong Public Cargo Working Area.



傍晚時分，沿著海濱長廊踏單車，能欣賞日落的美景，天空和海港都染上一片瑰麗的橘黃金色。

A bike ride along the promenade during the evening provides sweeping views of the harbour under a golden sky at sunset.



音樂噴泉富有動感的射燈效果與觀塘的燈光及霓虹燈互相輝映，構成美輪美奐的夜景。

The animated lighting effects of the music fountains combined with lighting of the district create spectacular night scenes.



園內海濱步道全長約 1 公里，是跑步的好去處。

The 1 km long waterfront boardwalk is a popular jogging spot.

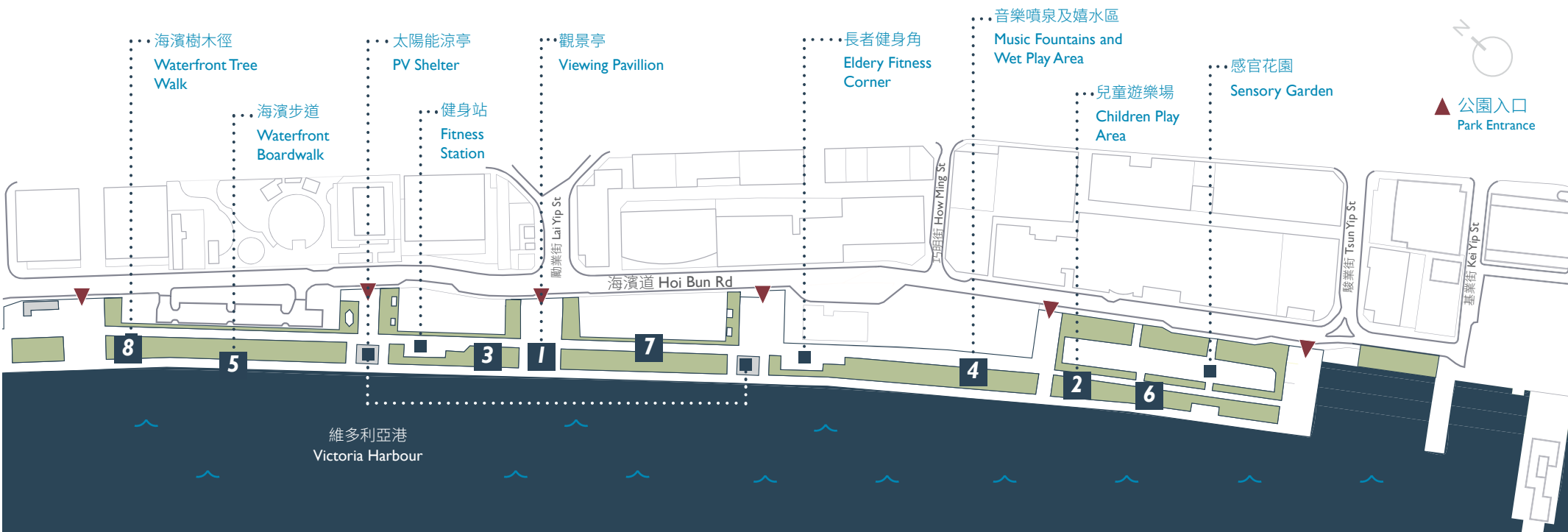

KT 01

觀塘海濱花園

Kwun Tong Promenade



上圖的海邊林蔭大道種了茂密的樹並設有長椅和遮蔭，為訪客創造了一個郁蔥、綠油油的休憩處。

The tree-lined avenue shown above are planted with canopy trees, along with benches and shade structures to create a lush and shaded rest area for visitors.

下圖的休憩區種滿了大量垂直綠化的攀緣植物，為遊人在炎炎夏日提供遮蔭。座位的位置稍高，視野廣闊，能清楚眺望海濱。

Seating areas shown below is shaded by vertical greening using climbing plants. Slightly elevated positions of the seating areas further expand views of the harbour.



水石榕 @ 海濱步道
Elaeocarpus hainanensis @ Waterfront boardwalk

花期

Flowering Period

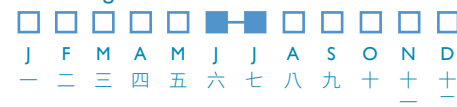

蒜香藤 @ 沿路涼亭

Pseudocalymma alliaceum @ Sidewalk pavilions

花期

Flowering Period

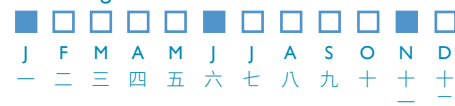

在海濱樹木徑沿途的長椅上休息，享受綠意盎然的環境，心境豁然開朗。

Taking a break at the benches along the Waterfront Tree Walk allows the visitors to enjoy the greenery with peace of mind.



KT
02

駿業街遊樂場 *InPARK*

InPARK（工業公園）是一個以工業風為主題的公園，設有露天的藝術展覽園地。這裏原名駿業街遊樂場，是一個面積約達 8,440 平方米的典型硬地球場，主要服務當時觀塘工業區的工人。隨着該區近年的轉型，遊樂場進行了兩期改善工程，吸引在附近工商大廈的上班一族在工餘時間舒展身心。

InPARK, which stands for Industrial Park, is a park designed in an industrial theme with open-air galleries. The site was formerly a traditional hard paved ballcourt known as Tsun Yip Street Playground with a total area of about 8,440 m². The park was initially built to serve factory workers around the Kwun Tong Industrial Area. Since the transformation of the district in recent years, the park has undergone two phases of renovation works. It attracts office workers from nearby commercial and industrial buildings to visit and unwind during their breaks.

KT
02

駿業街遊樂場

InPARK



InPARK 在人煙稠密的商業區發揮綠肺功能，並為在附近工作或生活的市民提供一個寧靜空間。
InPARK serves as a "green lung" in the densely-built commercial area, offering a place of serenity for users working or living in the neighbourhood.

2

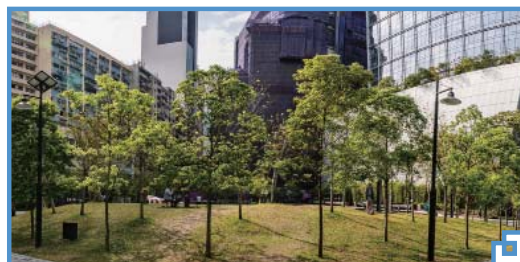

開闊的草坪不對稱地微微向草坪邊緣傾斜，種在外圍的樹木間距較疏，為休閒活動留出空間，並讓充足的陽光穿透樹冠。

The lawn is asymmetrically sloping towards the edge of Central Lawn, surrounded by sparse trees to leave room for leisure activities and let adequate sunlight penetrate through the tree canopies.

3



高大的樹木遮擋了公園外圍的商業大廈，亦包圍着中央草坪。在城東誌旁種植的竹樹形成一個建築環境向毗鄰綠肺過渡的空間。

Tall trees screen the commercial buildings and at the same time enclose the central lawn. The bamboo planted along Landmark East creates a transition from the built environment to the neighbourhood's green-lung.

4



多功能廣場設有籃球場，為各種活動提供了充滿活力的空間。

The Multi-purpose Square, featuring a half basketball court, offers a vibrant space for various active activities.

「駿業街遊樂場公共藝術計劃」於 2016 年 9 月展開，向本地藝術家及團隊公開徵集藝術作品提案，為「InPARK」添置公共藝術作品。

The "Public Art Scheme of Tsun Yip Street Playground" was launched in September 2016 to select public artworks for the InPARK through an open call for proposals from local artists and art groups.



■ 《織織綠織織》
"The Fabric Green"

織線用了可再生物料製造，織出具標誌性的「綠」布，寓意紡織行業邁向綠色產業的新動力。

The installation was created using recyclable materials that form a "green" fabric to signify the current trend in the textile industry of "going green".



■ 《花樣年華》
"Stitching Memories"

作品除了表達對投放著寶貴青春的女工們一份謝意，亦表揚她們對社會經濟發展作出的巨大貢獻。

The installation was a token of gratitude to women who spent their youth by the sewing machines, and honoured their significant contributions to the social and economic developments of the local community.



■ 《沉球》
"Cam4 Kau4"

「沉球」改變西瓜波的物料及形狀讓市民以坐、臥、倚靠的形式使用；而凹陷及埋藏的形態，代表着我們對過去的遺忘。

The shapes and materials of the "watermelon balls" were transformed for this sculpture so that people can sit, lay and lean on them. The balls, which appear to be deflated and sinking into the earth, represent traditions and old memories that have been forgotten.



KT
02

駿業街遊樂場

InPARK



KT
03

海濱道公園

Hoi Bun Road Park

海濱道公園原建於 1990 年，面積約 9,300 平方米，主要服務區內的工作人口。為配合九龍東轉型為另一個核心商業區，公園於 2021 年已完成翻新工程以配合市民大眾不斷轉變的需要。透過改善海濱道公園及沿路的街道面貌和過路設施，觀塘商業區和海濱得以連繫，將區內的人流及活力注入觀塘海濱花園一帶。改造後其中一個特色是巧妙利用綠籬、涼亭、屏風等設施分隔開街道的繁囂，同時保留背後富變化的城市景觀，為中央草坪營造理想氛圍。

Hoi Bun Road Park was built in 1990, with an area of about 9,300 m², mainly to serve the working population in the area. To facilitate the transformation of East Kowloon to another central business district, the Park was refurbished in 2021 to cater for the changing needs of the general public. Through upgrading of the Park, streetscapes and road crossing facilities along Hoi Bun Road, the connection of Kwun Tong commercial district and the promenade has been enhanced, which draws visitors from the neighbourhood and energises the Kwun Tong Promenade. The refurbished Park strategically screens off noise from street background with greenery, screening panels, pavilions and other ancillary facilities, while preserving the vibrant urban landscape as a backdrop and creating an ideal atmosphere for the central lawn.

KT
03

海濱道公園

Hoi Bun Road Park



■ 以回收木材升級再造的長椅
Featured bench made by upcycled wood



■ 可再生竹材用於屏風及座椅
Use of renewable bamboo applied on screens and seatings



■ 利用自然光以節省能源
Utilise natural light to save energy

1 圓形的中央草坪四周設有綠籬及涼亭等作「隔音屏障」，成為鬧市中寧靜的綠洲，亦兼具多功能的戶外劇場空間。
The central lawn is surrounded by green hedges and pavilions as "noise barriers," creating a tranquil oasis in the bustling city, while also serving as a multi-purpose outdoor theatre.

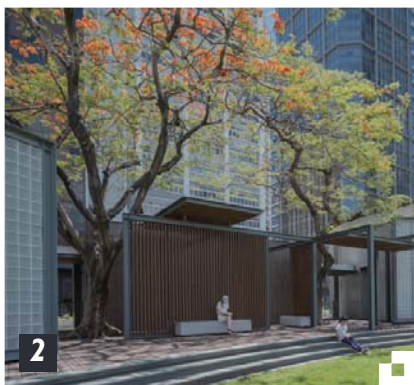

公園保留的鳳凰木與新建築交織，其傘形遮蔭成為了半開放的活動空間。

The preserved *Delonix regia* interlaces with newly built architecture to form "umbrella-shaded" semi-open activity space.

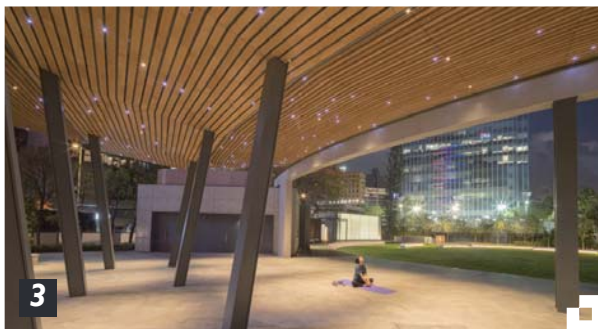

涼亭配合繁星燈效可作為特色表演場地。

The pavilion lit up by starlight lightings can serve as featured performance area.

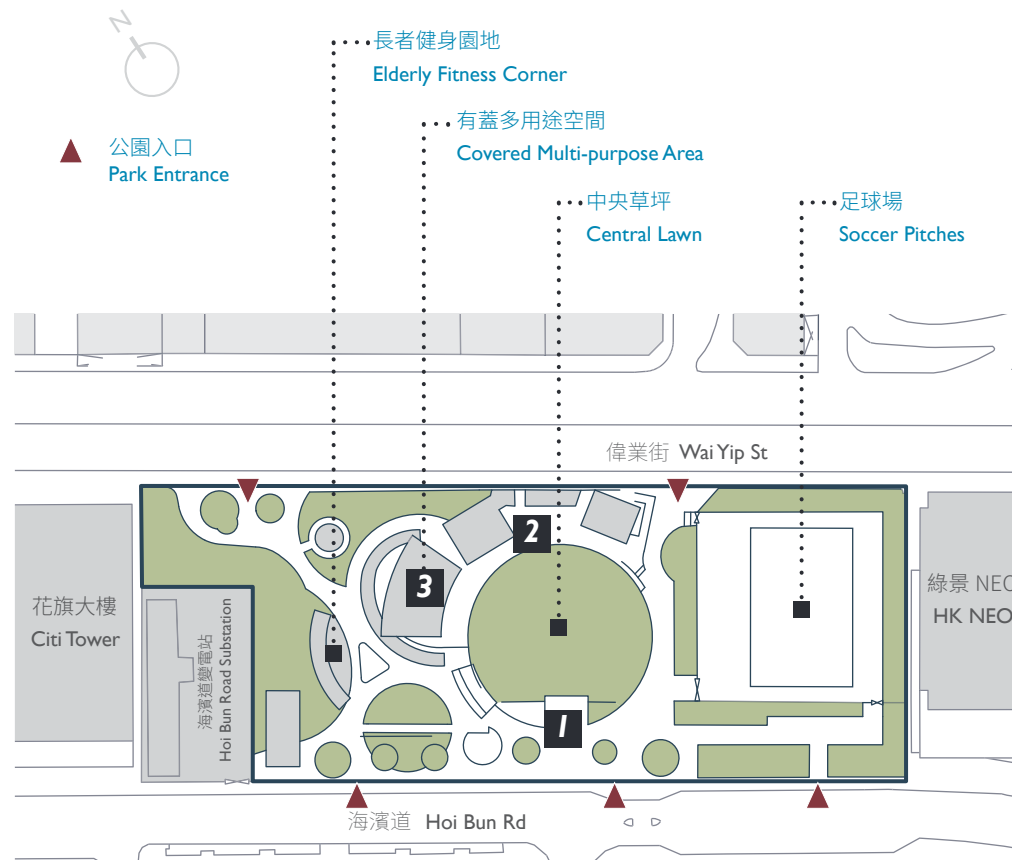



KT
04

茶果嶺海濱公園 *Cha Kwo Ling Promenade*

為配合觀塘區的未來發展，渠務署進行觀塘污水泵房優化工程，興建地底污水調節設施，以提升處理污水的效能。為落實「一地多用」的政策倡議，署方於泵房上蓋建造園境平台，連同毗鄰的海濱空間組成佔地約 1.8 公頃的茶果嶺海濱公園。

To cater for the future development of the Kwun Tong district, the Drainage Services Department (DSD) implemented enhancement works for the Kwun Tong Sewage Pumping Station (KTSPS). An underground balancing facility was constructed to improve the efficiency of sewage treatment capacity. In response to the "single site, multiple use" initiative, DSD transformed the rooftop of the pumping station into a landscaped green platform, which connects with the adjacent waterfront area to form the 1.8 hectare Cha Kwo Ling Promenade.



KT
04

茶果嶺海濱公園

Cha Kwo Ling Promenade

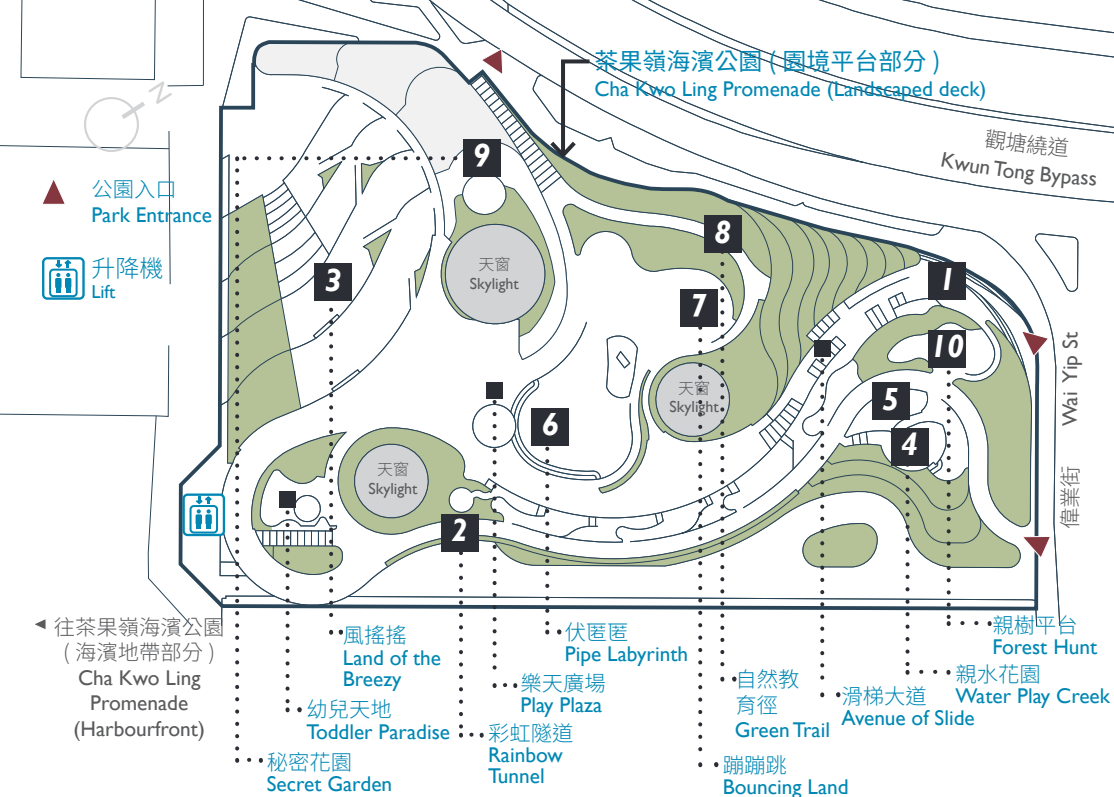

公園的綠化與玩樂等空間分佈相輔相成，帶出刺激五感的「好玩自然」概念。

The fabrics of greening and play areas in the Promenade complement with each other and bring out the concept of "playful nature" that stimulates the five senses.

滑梯大道利用 10 米的高低差距設計成別具特色的滑梯和攀爬遊樂設施。

Utilising the 10m-level-difference to form featured slides and climb play equipment at the Avenue of Slide.



園內設有形狀不一的彩虹顏色玻璃結構，太陽光線穿透玻璃，讓玻璃的顏色照射在地面上。

The park features glass structures of various shapes and rainbow colours, allowing sunlight to filter through.



一邊盪鞦韆，一邊欣賞維港人醉人美景，令人樂而忘返。

Swinging while enjoying the scenic view of the Victoria Harbour is a captivating experience.

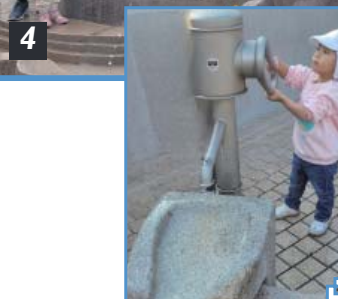

嬉水區設有噴水裝置，帶來涼快的觸感玩樂體驗。

The water play area is equipped with sprinklers, providing an experience of refreshing sensory play.



親樹平台的繩網攀爬架及滑梯達 8 米高，挑戰膽量同時有置身於樹頂的體驗。

The climbing and slide tower at Forest Hunt reaches a height of 8 m, challenging one's courage while bringing a treetop observation experience.



玩水區開放時段：上午 8 時至晚上 8 時

Splash Pad Opening hour: 8 am to 8 pm

KT 04

茶果嶺海濱公園

Cha Kwo Ling Promenade



6

水管材質的矮牆帶有渠務署的建築特色，是玩伏匿的基地。

The parapet walls made with water pipe material is a perfect spot for playing hide and seek.



7

蹦蹦跳區域設有彈跳玩樂設施，並有兔子裝置呼應主題。

Bouncing land is equipped with jumpy play facilities and rabbit characters to echo with the theme of the area.



紅花風鈴木 @ 偉業街入口
Tabebuia rosea @ Wai Yip St Entrance

花期
Flowering Period



果期
Fruiting Period



每年二月至三月是紅花風鈴木開花的日子，歡迎親臨海濱公園體驗大自然的美麗！

Every year from February to March, the pink flowers of *Tabebuia rosea* blossom in full glory. Get ready to witness the stunning beauty of nature by visiting the Cha Kwo Ling Promenade!



8

在自然教育徑可找到香港的原生品種，它們不僅能為野生動物提供食物和棲息地，也能更適應香港的氣候，抵抗病蟲害。

Native plant species of Hong Kong can be found in the Green Trail. These plants not only provide food and habitats for wildlife but are also better adapted to Hong Kong's climate and more resistant to pests and diseases.



9

秘密花園種植了符合小童觀賞高度的植物，營造一個專為小朋友而設的隱閉空間。

The Secret Garden is filled with plants at a height suitable for children to observe, creating a secluded space designed just for them.

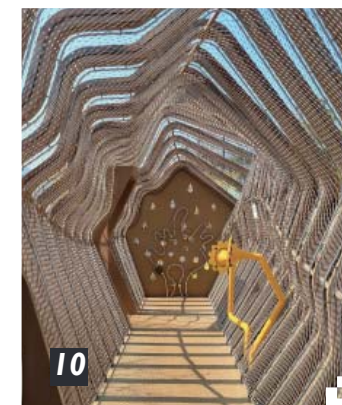

10

親樹平台樹屋上的「龍骨」利用了本港回收的台灣相思木，並由本地的工匠升級再造而成。

The "keel" of tree tower in the area of Forest Hunt is crafted from recycled *Acacia confusa* and has been upcycled by local carpenters.

KT
04

茶果嶺海濱公園

Cha Kwo Ling Promenade



2

海濱地帶是共融和多用途的臨海開放空間，地面流動的圖案如舞動的絲帶，為海濱增添活力。

The harbourfront area is an inclusive and multifunctional open space by the sea, with flowing patterns on the ground resembling dancing ribbons, adding vitality to the waterfront.



3



4



5

回收本港的台灣相思木升級再造了長枱和椅，配以水管的結構，充滿環保意念。

Local acacia wood was upcycled to create long tables and benches with structure made from water pipes, featuring eco-friendly concept.

茶果嶺海濱公園
(海濱地帶部分)
Cha Kwo Ling Promenade
(Harbourfront)

▲往翠屏海濱
To Tsui Ping Seaside

往茶果嶺海濱公園
(園境平台部分)
To Cha Kwo
Ling Promenade
(Landscaped Deck)

以「先駁通，再優化」的理念，觀塘海濱與茶果嶺海濱提早完成接駁。

The "incremental approach" concept was put forward to enable the waterfront of Kwun Tong and Cha Kwo Ling connect ahead of schedule.

健身設施
Fitness Equipment

涼亭
Shelter

遊樂設施
Play Equipment

公園入口
Park Entrance

升降機
Lift

▼往偉樂街
To Wai Lok St



KT
05

翠屏河畔長廊 *Tsui Ping Riverside Promenade*

「活化翠屏河」項目實踐「河畔城市」概念，提升河道生態及景觀設計，活化全長約1公里的翠屏河畔長廊，提供河畔公共空間及以新建跨河通道加強區內連繫。項目亦挖深翠屏道至敬業街一段河床，在河道上游安裝擋水牆，以提升河道防洪能力，並降低觀塘區的水浸風險。此外，翠屏河花園亦為河畔提供一個中型的休憩空間，而河口的翠屏海濱跨河通道，則貫通了茶果嶺及觀塘海濱。

Revitalisation of Tsui Ping River project implemented "Rivers in the City" concept by enhancing river ecology and landscape design. The 1 km long Tsui Ping Riverside Promenade provides a riverside public space and cross-river pedestrian walkways to improve connectivity within the district. The project has also increased the river's flood carrying capacity and reduced the flood risk of Kwun Tong District by deepening a portion of the riverbed from Tsui Ping Road to King Yip Street, and by installing flood walls upstream. Furthermore, the Tsui Ping River Garden provides a medium-sized recreational ground for the riverfront, while the cross river walkway at the Tsui Ping Seaside links the Cha Kwo Ling and Kwun Tong waterfront as one.

KT
05

翠屏河畔長廊

Tsui Ping Riverside Promenade

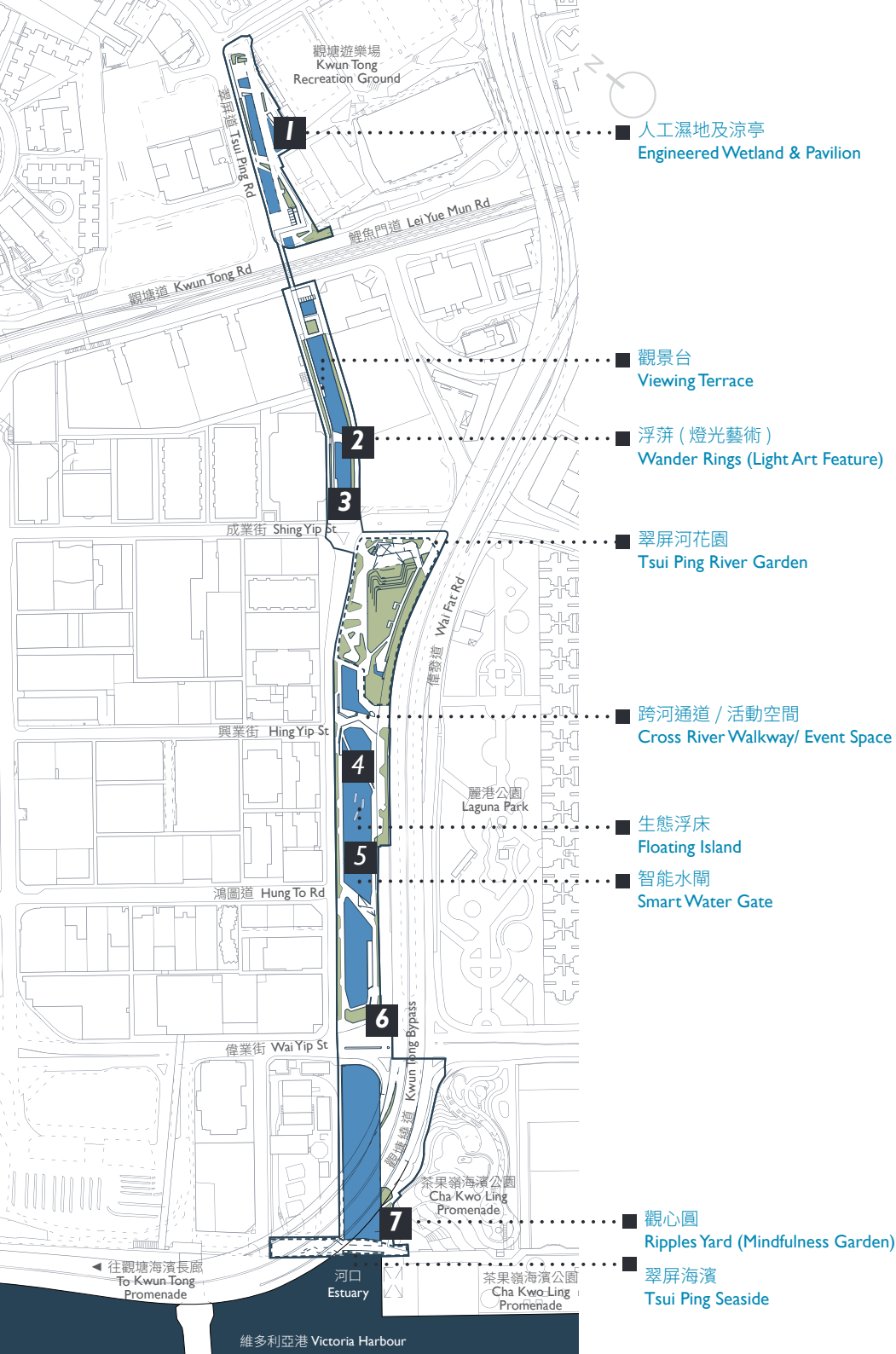

■ 翠屏河畔長廊

Tsui Ping Riverside Promenade

翠屏河畔長廊每個河段各有特色，包括上游的人工濕地、中游的林蔭走廊、中下游的浮島及生態浮床以及下游的翠屏海濱。河道是一個綠色中軸線，不單貫通兩岸的住宅區及工商業區，亦串連區內多個休憩空間。

The different sections of Tsui Ping Riverside Promenade comprised different features, including the wetland at upstream, the green corridor at mid-stream, the floating pontoon and floating island at mid-to-downstream and the Tsui Ping Seaside at downstream. Being a green spine, the river connects the residential and industrial cum commercial areas on both sides, and also links multiple recreational areas in the vicinity.



人工濕地可作戶外教室，展示生態窪地及水生植物。

Engineered wetland acts as an outdoor classroom showcasing bioswales and aquatic plants.



近敬業里段 50 多棵成熟的細葉榕樹在項目中得以保留，成為林蔭走廊。

50 mature Chinese Banyan Trees (*Ficus microcarpa*) were conserved near King Yip Lane to form a green corridor.



燈光藝術裝置「浮萍」置於跨河通道上，為工業區的河畔一帶增添特色。

The light art installation "Wander Rings" is placed on cross river walkway and brings delight to the riverfront within the industrial area.



浮島是位於翠屏河中央的觀景台，為公眾提供近水的步行體驗及河畔公共空間。

The floating pontoon serves as an observation deck located at the centre of the Tsui Ping River, offering near-water travelling experience and riverside open space to the public.



因應預測的天氣狀況而升降的智能水閘，以新技術管理河道水位，維持最大的排洪能力。

An intelligent water gate smartly adjusts its rise and fall according to the forecasted weather conditions, managing the water level of the river with advanced technology and maintaining maximum drainage capacity.



翠屏河設 6 條跨河通道、1 座浮島和 6 個觀景平台，以增強附近住宅和商業區的連接性。

There are 6 cross river walkways, a floating pontoon and 6 viewing decks to enhance connectivity for the nearby residential and business areas.



觀心圓利用高架橋下的空間，營造減壓的禪意園境。

The Ripples Yard fully utilised the understorey space of the elevated road to create a tranquil zen landscape.



鳥桿
Bird Perch



岩石池
Rock Pool

在河道不同地方設有鳥桿、岩石池、潮汐池、生態牆、生態浮床等生態裝置，為河道生態創造有利環境。

Ecological installations along the river are provisioned including bird perches, rock pools, tidal pools, ecological walls and floating islands, which create favourable conditions for the river ecosystem.



小白鷺
Egretta garzetta



黑領棕鳥
Gracupica nigricollis



白頸鴉
Corvus torquatus

■ 翠屏河花園 Tsui Ping River Garden

為更善用土地及加強鄰近與翠屏河計劃的協同效應，成業街休憩花園已重置並優化為翠屏河花園，以改善環境及加強區內連繫。整個翠屏河花園已於2019年全面開放，為市民提供舒適的公共休憩空間。

To optimise land use and synergising with the adjacent Tsui Ping River project, Shing Yip Street Rest Garden was relocated and regenerated as Tsui Ping River Garden to improve the environment and enhance connectivity in the area. The entire Tsui Ping River Garden was opened to the public in 2019 to provide a cozy public open space for the community.

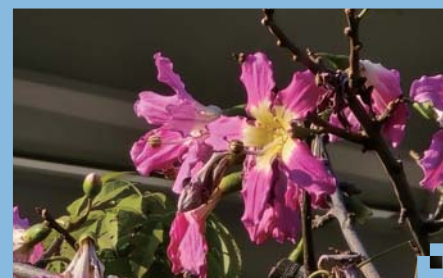

絲木棉 @ 多用途廣場
Chorisia speciosa @ Multi-purpose area

花期 Flowering Period



宮粉羊蹄甲 @ 斜草坪
Bauhinia variegata @ Inclined lawn

花期 Flowering Period

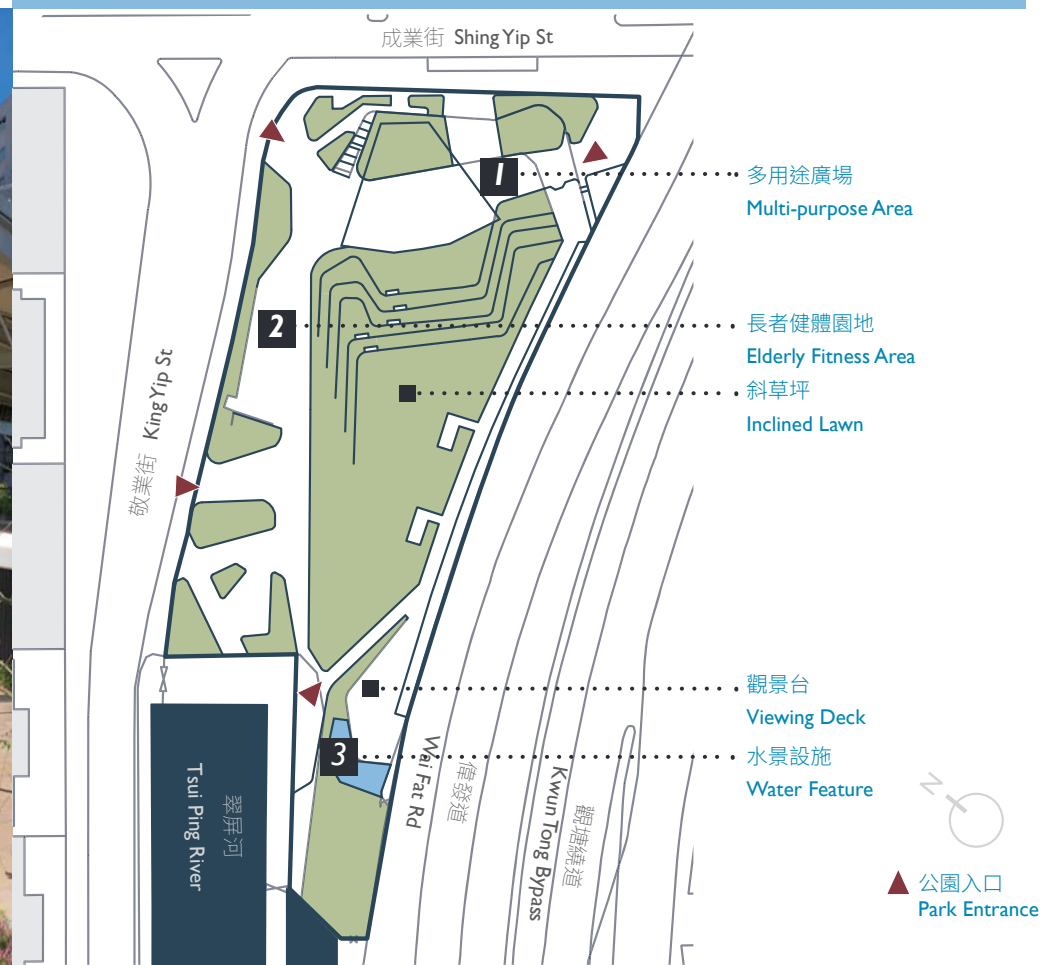

KT
05

翠屏河畔長廊

Tsui Ping Riverside Promenade

1

公園設有階梯式座位，供市民休憩或觀賞在附近舉辦的活動。

Stepped seats are provided for the public to rest or enjoy the activities in the Park.



2

多元化的設施滿足如兒童及長者等不同社區群體的各式各樣需求。

Various facilities are provided to satisfy the diverse needs of different community groups including children and elderlies.



3

特色水景讓遊客享受片刻寧靜。

Water feature creates a tranquil moment to the visitors.

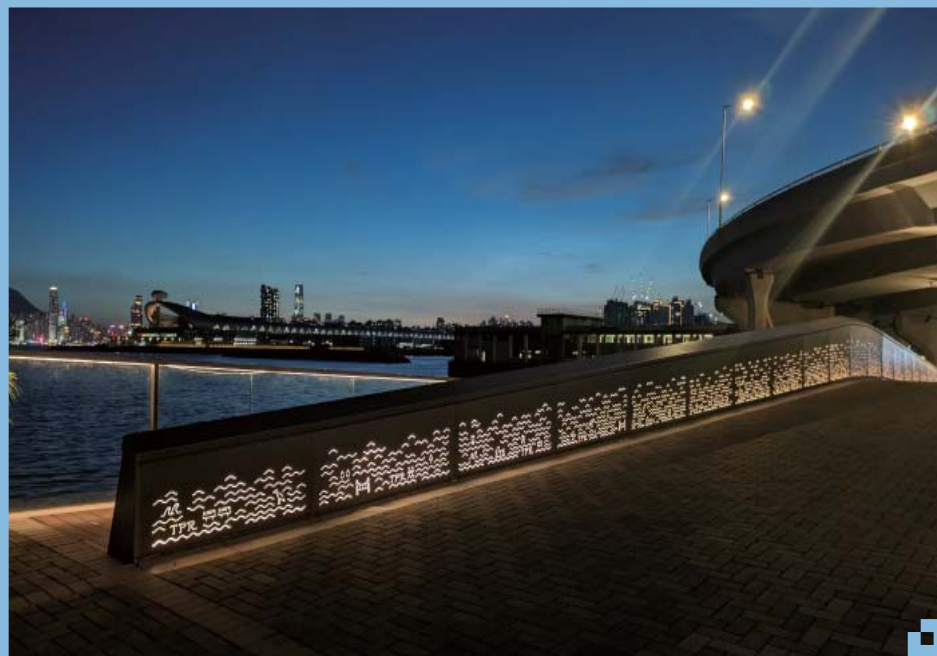

翠屏海濱

Tsui Ping Seaside

茶果嶺海濱公園連同旁邊的翠屏海濱跨河通道，貫通觀塘與茶果嶺長約 1.7 公里的海濱空間，增加觀塘區的整體連繫性及九龍東海濱的暢達性。

Cha Kwo Ling Promenade, together with the adjacent Tsui Ping Seaside, connects an about 1.7 km of waterfront area that runs through Kwun Tong and Cha Kwo Ling, enhancing the overall connectivity of the Kwun Tong area and the accessibility of the Kowloon East waterfront.



吉祥物「翠屏雀」以常見於翠屏河的小白鷺為原型打造，將靈動的水鳥形象融入沿河不同的區域。這種視覺敘事手法不僅塑造了翠屏河獨特的品牌形象，更配合在地化設計以增強社區居民的認同感。

'Tsui Ping Birdie', a mascot modelled after the Little Egrets often spotted at Tsui Ping River, is a dynamic waterbird imagery used in this riverside. This visual narrative not only establishes the river's distinctive identity, but also strengthens the community's sense of belonging through localised design.

KT
05

翠屏河畔長廊

Tsui Ping Riverside Promenade

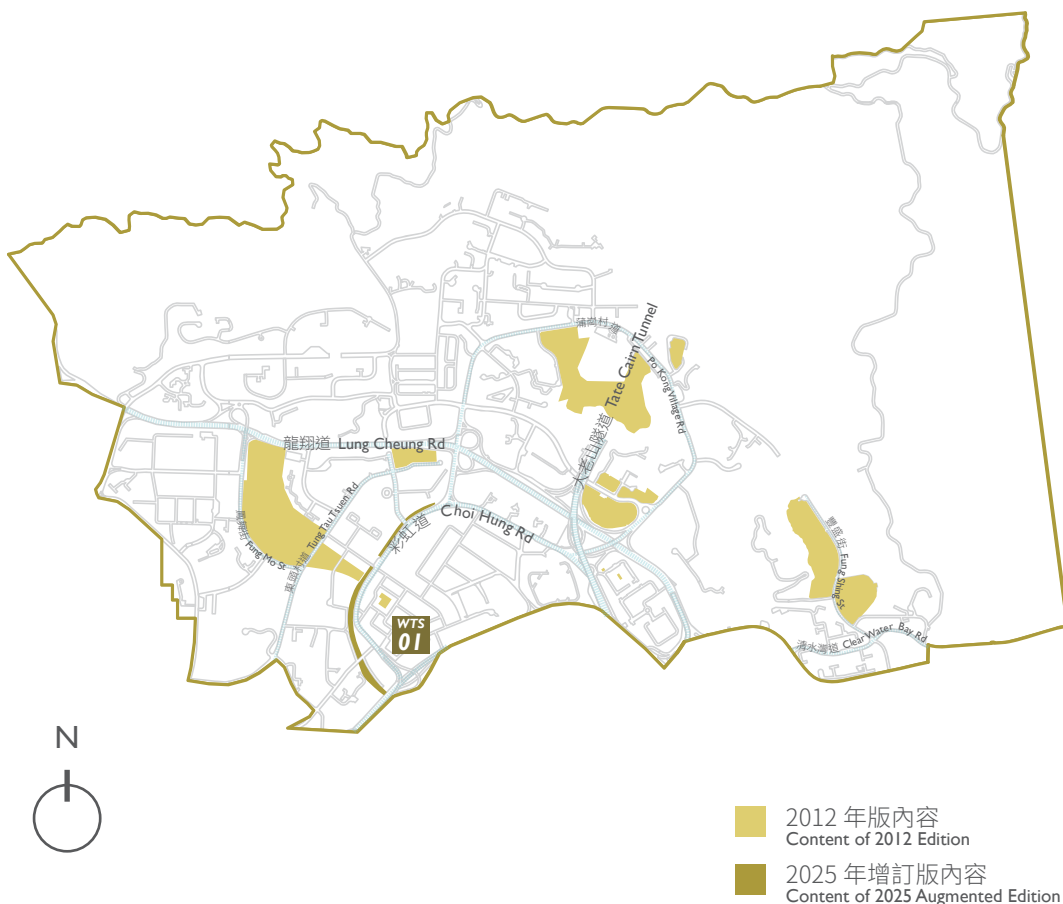

黃大仙區 Wong Tai Sin District

黃大仙區公私營住宅林立。近年，區內積極提升排洪基建，打造綠化河道走廊，營造更佳的行人環境，並創造高質素的休憩空間。讓市民無論是在步行、閒坐還是放鬆的時刻，都能享受到宜人的綠化公共空間。

Wong Tai Sin district features a variety of public and private housing developments. In recent years, the district has made significant strides in upgrading its drainage infrastructure, creating green river corridors, enhancing the pedestrian environment and establishing quality recreational spaces. Residents can enjoy pleasant green public spaces, while they are walking, sitting out, or simply relaxing within the district.



啟德河
Kai Tak River



WTS
01

啟德河 Kai Tak River

啟德河舊稱為啟德明渠，總長約 2.4 公里，是東九龍其中一條主要排洪渠道。由於受近年城市發展及極端天氣影響，彩虹道在暴雨期間曾出現嚴重水浸，影響附近居民生活。為提升啟德河的排洪能力及減低相關地區的水浸風險，渠務署於 2011 年 10 月起於黃大仙區內展開長 1.1 公里的渠段改善工程，並於 2018 年完成及開放沿河路徑予市民享用。

Known as Kai Tak Nullah in the past, the approximate 2.4 km long Kai Tak River is one of the East Kowloon's major drainage channels. Due to urban developments and extreme weather conditions in recent years, serious flooding occurred in Choi Hung Road during rainstorms, affecting nearby residents. In order to increase the drainage capacity of Kai Tak River and mitigate flooding risk of surrounded area, the Drainage Services Department implemented river improvement works in stages to improve the 1.1 km section of the nullah in Wong Tai Sin district since October 2011. These improvement works were completed in 2018 and with trail along the river opened to public for enjoyment.

WTS
01

啟德河

Kai Tak River

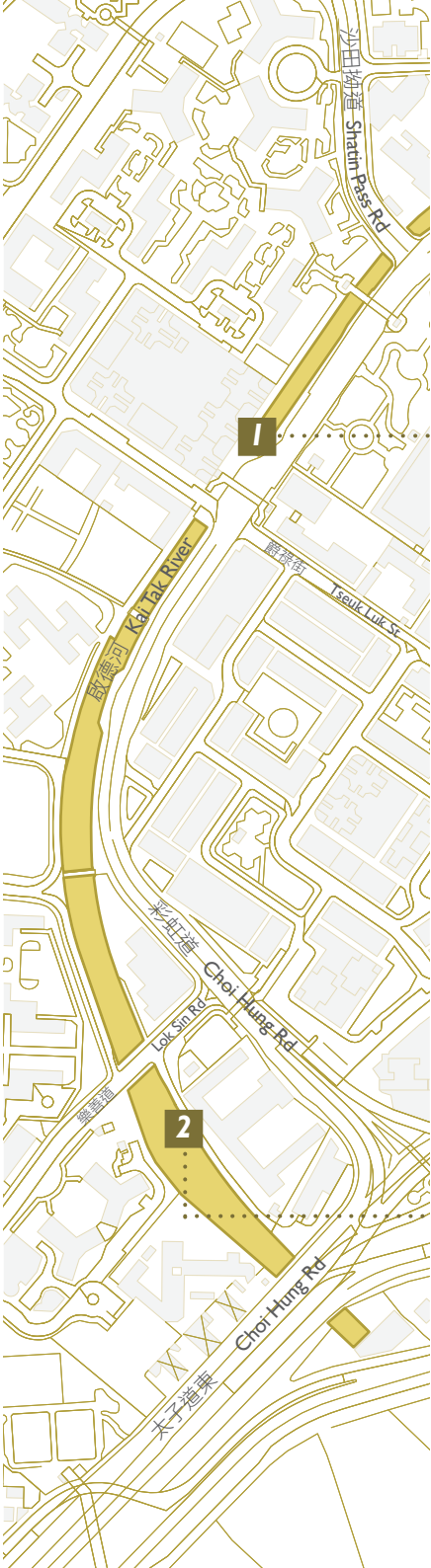

1 河岸花槽
Riverside
Planter

2 魚洞穴及導流石
Fish Shelter &
Flow Reflector



在啟德河河岸兩旁種植季節性懸垂植物如簕杜鵑，營造具有特色及主題的啟德河景觀。

Seasonal plants such as *Bougainvillea spectabilis* have been planted along Kai Tak River to create a special and thematic scenes of Kai Tak River.



簕杜鵑
Bougainvillea spectabilis

花期 Flowering Period



簕杜鵑在本港全年有花可見。鮮色的部分其實是苞片，中央白色不顯眼的部分才是其花瓣。

Bougainvillea spectabilis is flowering all year round in Hong Kong. The part with brilliant colours are its bracts, while the white parts in the middle of the bracts being inconspicuous are its true petals.

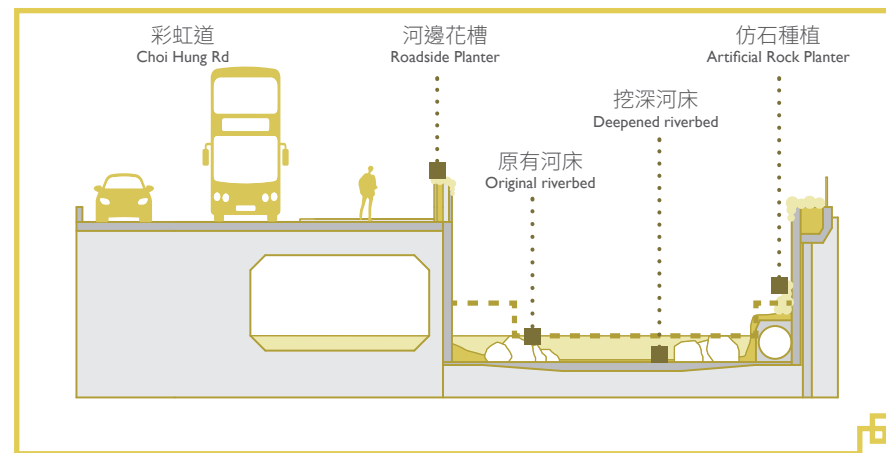

啟德河床旁邊加設魚洞穴以提供魚類棲息地。
Fish shelters were added at the sides of river bed to provide habitat of the fish.



烏頭
Mugil cephalus (Grey Mullet)



花身鯽
Terapon jarbua (Jarbua Terapon)

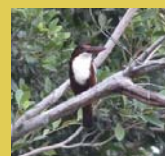

白胸翡翠
Halcyon smyrnensis

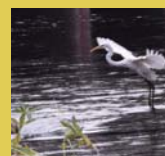

大白鷺
Ardea alba



夜鷺
Nycticorax nycticorax



2

在魚穴旁相應位置加設導流石，以改變水流方向及減低流水速度，供魚類在河道水流較急時休息，同時吸引不同鳥類在附近覓食。

Flow deflectors were added at suitable locations next to fish shelters to induce variations in river flow direction and velocity. They provide refuge for fish in strong river flow and attract different birds to forage nearby.



九龍城區

Kowloon City District

九龍城區的西面盛載著舊城面貌和豐富的歷史文化，而東面的前啟德機場在重建後亦逐漸形成嶄新的住宅、商業、體育及休閒娛樂區域。九龍城區的綠化空間展現了新舊交融的設計特色，結合動態、靜態及互動的遊樂設施，體現當區的獨特性和健康城市概念。

The Kowloon City district carries the fabrics of an old townscape with rich culture on the west. While on the eastern part, where the Kai Tak Airport was once located, it is gradually transforming into a brand new residential, commercial, sports and recreational area. The green spaces in the Kowloon City district also showcase a blend of old and new design features, integrating active, passive and interactive recreational elements that embrace the area's uniqueness and the concept of a healthy city.

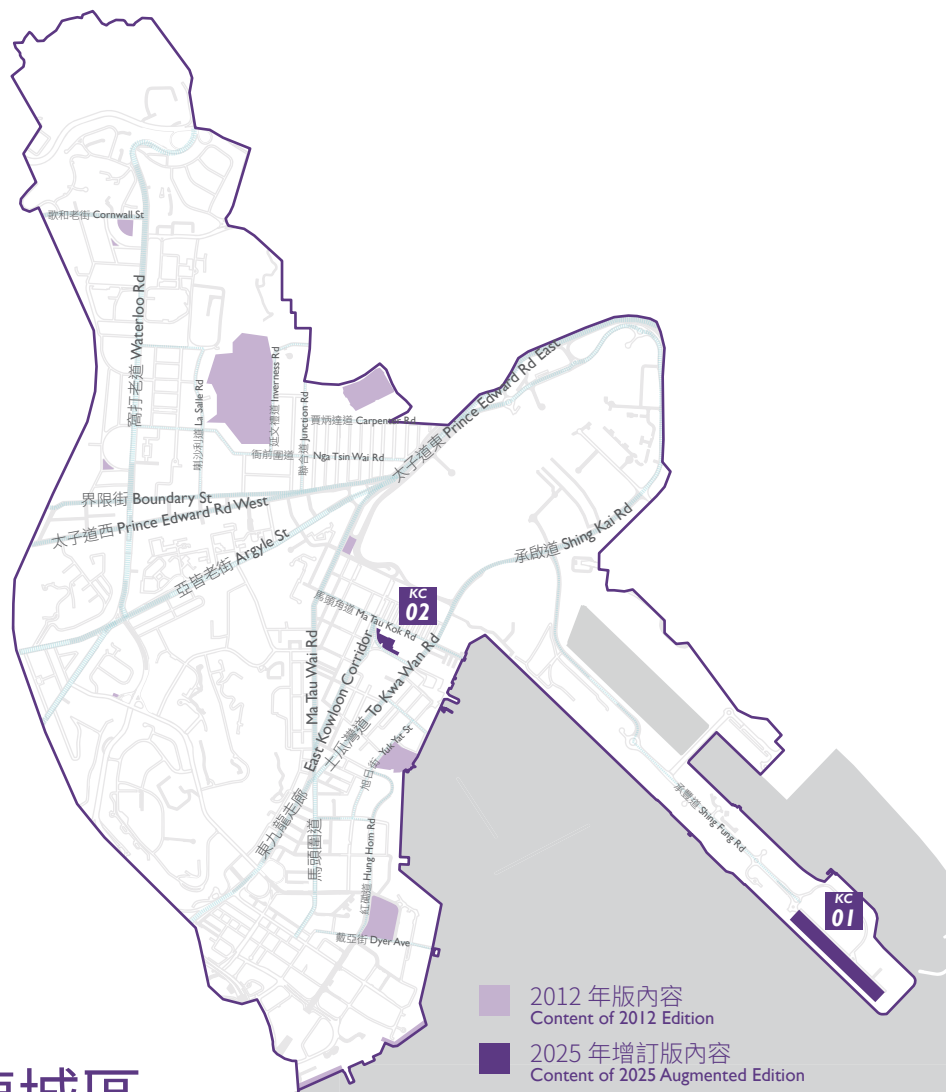

KC
01

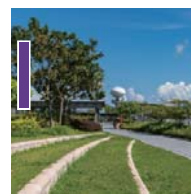

啟德郵輪碼頭公園
Kai Tak Cruise Terminal Park

KC
02



牛棚藝術公園
Cattle Depot Art Park



KC
01

啟德郵輪碼頭公園

Kai Tak Cruise Terminal Park

啟德郵輪碼頭公園位於啟德郵輪碼頭頂層平台，面積達 23,000 平方米，園內設有多項設施，包括中央草坪、水景花園及噴泉廣場等。公園擁有 360 度的環迴景致，香港島、維多利亞港及九龍的風景一覽無遺，平台上亦配以狼尾草以襯托飛鵝山及獅子山的壯麗景色。

The Kai Tak Cruise Terminal Park is located at the rooftop of the Kai Tak Cruise Terminal. It covers an area of 23,000 m² with facilities including a central lawn, water garden and fountain plaza. The park offers spectacular 360 degrees panoramic views of Hong Kong Island, Victoria Harbour and Kowloon, as well as the stunning views of the nearby Kowloon Peak and Lion Rock complemented by the Purple Fountain Grass planted on the deck.

KC
01

啟德郵輪碼頭公園

Kai Tak Cruise Terminal Park

▲ 往承豐道方向
Direction to
Shing Fung Rd

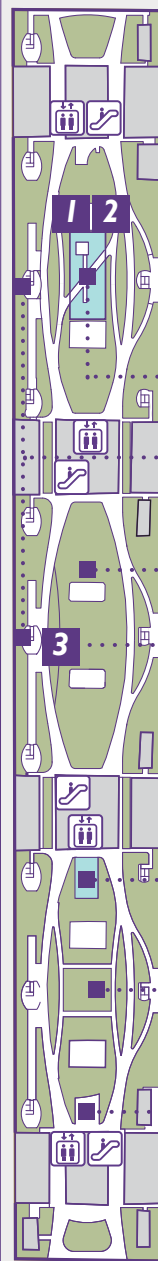

啟德郵輪碼頭
Kai Tak Cruise
Terminal

水景花園
Water Garden

觀景平台
Viewing
Platform

中央草坪
Central Lawn

觀景台階
Viewing Steps

噴泉廣場
Fountain Plaza

公園廣場
Park Plaza

升旗平台
Flagpole
platform



升降機
Lift

扶手電梯
Escalator



睡蓮 @ 水景花園
Nymphaea tetragona (Pygmy water-lily)
@ Water Garden
花期 Flowering Period



錦繡杜鵑 @ 觀景平台
Rhododendron × pulchrum @ Viewing Platform
花期 Flowering Period

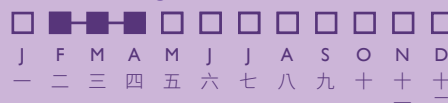

狼尾草 @ 中央草坪
Pennisetum alopecuroides
(Purple Fountain Grass) @ Central Lawn
花期 * Flowering Period*



* 修剪後亦會開花

* Flowering also after pruning



水景花園是園區之重點打卡位，池塘內種植了不同品種的濕地植物，為空曠的園景注入清涼感覺。沿着以木地板建造的小徑穿梭，能欣賞不同的觀賞植物。

The Water Garden is the main photo-taking spot of the park. Its pools help cooling the open landscape spaces and include a variety of aquatic plant species. Various ornamental plantings can be seen by strolling along the boardwalk.



寬闊的階梯鋪上綠草，形成了靈活的空間，訪客可以席地而坐，一邊觀賞海景一邊休息或野餐。Stone steps with wide lawn platforms provide casual seating areas for people to sit, picnic and enjoy the views of the Harbour.



KC
02

牛棚藝術公園

Cattle Depot Art Park

佔地 7,000 平方米的牛棚藝術公園位於土瓜灣，是香港碩果僅存的戰前牛隻屠房一部分，另一部分現已被翻新和改建為藝術村。古物諮詢委員會於 2009 年把牛棚評為二級歷史建築。

Occupying an area of 7,000 m², the Cattle Depot Art Park, located at To Kwa Wan, is part of Hong Kong's only surviving pre-war cattle slaughterhouse, with the remaining part of which was renovated into an Arts Village. The depot was confirmed a Grade II historic building by the Antiquities Advisory Board in 2009.

KC
02

牛棚藝術公園

Cattle Depot Art Park

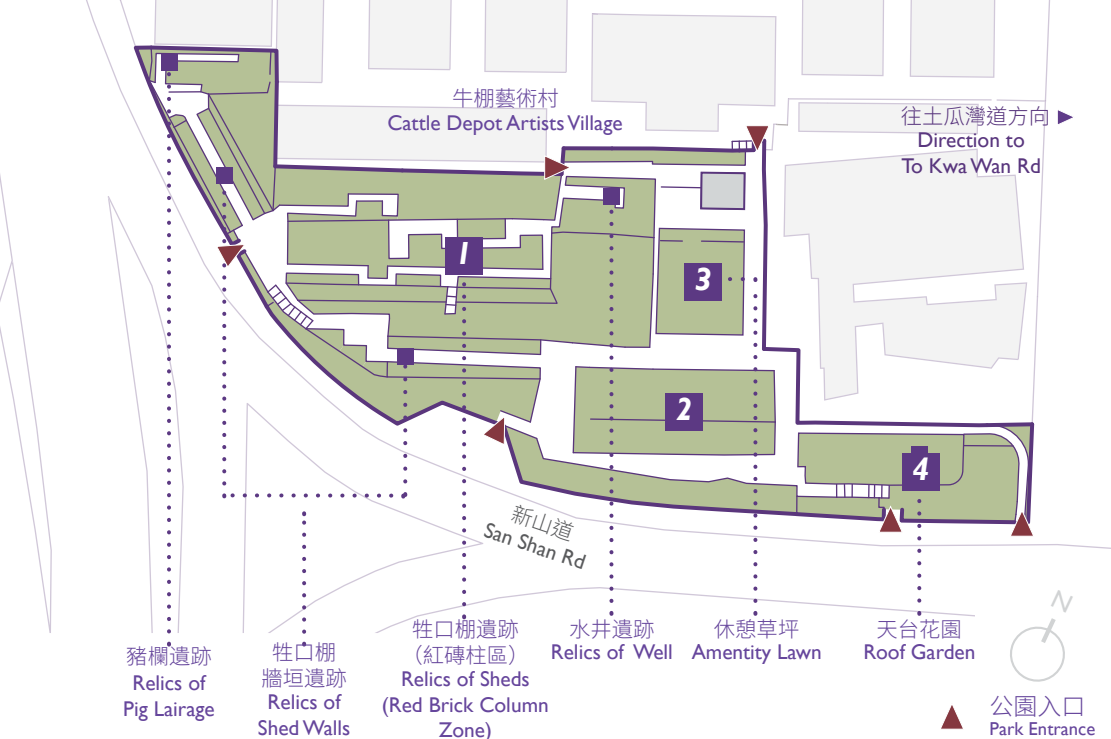

紅磚牆和以混凝土作結構柱的牲口棚被保留下來。飲水槽底部的金屬環用於繫綁牛隻。

Shed with red brick wall and concrete columns were preserved. The metal rings in front of the feeding trough were used for tying cattle.



在牛棚停止營運後，原有的棚柱和飲食槽仍被保留。四周的植物在當中滋蔓生長，逐漸形成建築結構與大自然交纏結合的奇妙形態。

When the Cattle Depot ceased operation, the columns of the sheds and the feeding troughs remained and they were eventually taken over by the surrounding vegetation, resulting in an intriguing composition of architectural structure and nature.



筆管榕
Ficus subpisocarpa

花 / 果期 Flowering/ Fruiting Period



細葉榕
Ficus microcarpa

花 / 果期 Flowering/ Fruiting Period



此公園主要的榕屬樹有筆管榕和細葉榕。大小適中的榕果是雀鳥最喜歡的食物，有利種子散播。

The major Ficus species found in this Park are *Ficus subpisocarpa* and *Ficus microcarpa*. The moderate size of Ficus fruits make them favourite food for birds which help disperse seeds.



圍欄上以金屬片形成豬、牛等有趣造型，以展示當年屠房的情況。

Metal plates on the fences are incorporated with interesting decorations, such as pigs and cows, telling the story of the former slaughterhouse.



間隔砌磚法是日漸流行的建築方式，展示紅磚的質感及紋理。磚與磚之間的罅隙既通風又可種植，營造更柔和的效果。

"Hit and miss" brickwork is an increasingly popular type of masonry displaying the texture and pattern of the red bricks. The gaps between bricks allow aeration and planting.